

## Top view

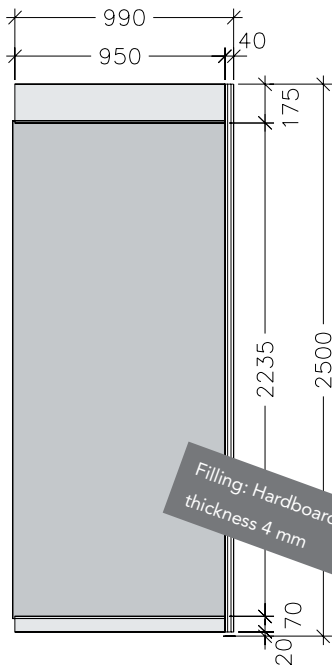

## Front view



## Wall element OCTANORM

comprising:

- **Supports:** 8-chamber profile Ø 40 mm, 2500 mm incl. height adjustable base, 20 mm
- **Struts:** top: 175 mm x 16 mm x 950 mm  
bottom: 70 mm x 16 mm x 950 mm
- **Wall filling:** Hardboard, plastic-coated, white thickness 4 mm  
Also available with cork coating (pins may be used), OSB-filling and with cover in your preferred colour (at a surcharge).

### Please note:

For static reasons, it is necessary to place a retaining wall after at least 4 lin. metres.

see form 1.18 01

## Top view

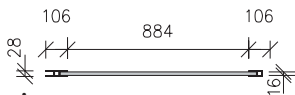

## Front view

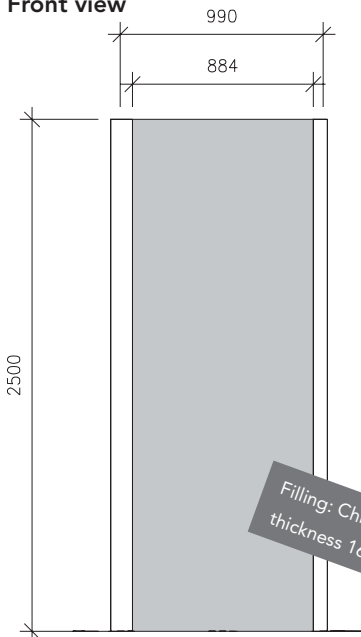

## Wall element M&S

comprising:

- System fastener in silver (28 mm x 106 mm for straight fastening)
- Wall element, plastic-coated surface, colour: light grey RAL 7035, Visual range: 884 mm x 2500 mm x 16 mm
- Also available with textile cover in anthracite (pins may be used, sound-absorbing), OSB filling, maple decor and with cover in your preferred colour (at a surcharge)

### Please note:

For static reasons, it is necessary to place a retaining wall after at least 4 lin. metres.

see form 1.18 02

Event name	Company name (Invoice recipient)
Customer no. (Exhibitor)	Contact person (Invoice recipient)
Hall/stand no. (Exhibitor)	Street and house no. (Invoice recipient)
Your order no. (if desired)	Postcode, town, country (Invoice recipient)
VAT identification number EU (Invoice recipient)	Telephone (in case of questions)
We are: <input type="checkbox"/> Entrepreneur <input type="checkbox"/> no Entrepreneur	E-mail (in case of questions)

Orders by fax to: +49 711 18560-2292

## 012211801

We herewith order / We order on behalf and by order of the aforementioned exhibitor from Landesmesse Stuttgart GmbH (LMS) – and at the same time accept the General Terms and Conditions for Services as well as the Technical Guidelines of LMS which are available at [www.messe-stuttgart.de/agb](http://www.messe-stuttgart.de/agb) and also on-site in the service center – as follows:

Item No.	Variant	Quantity	Description	Unit price EUR
01-120	0 1		Wall element OCTANORM white, plastic-coated 990 x 2500 x 4 mm	44.30 / lin. m.
01-021	9 9		Wall element OCTANORM coated with cork, suitable for use with pins, 990 x 2500 mm	46.00 / lin. m.
01-122	9 9		Wall element OCTANORM (with OSB-filling) wall filling: oriented strand board natural, 990 x 2500 x 16 mm	44.30 / lin. m.
01-156	0 1		Fascia, white, 4 mm, 2500 x 400 mm, to be fixed to wall element, incl. standard lettering (Helvetica, semibold, black), max. 20 letters	78.00 / pc.
01-157	0 1		Fascia, white, 4 mm, 1500 x 400 mm, to be fixed to wall element, incl. standard lettering (Helvetica, semibold, black), max. 20 letters	52.40 / pc.
01-605	0 1		One-leaf door element, white	119.30 / pc.

Exact text for your fascia lettering (please complete) \_\_\_\_\_

Stand partition walls are **not included** in the stand area rental. Please note that for static reasons it is absolutely necessary to install **retaining walls** every 4 linear metres. The number and placement of these walls depends on the stand shape and size and can be seen in the stand sketch. These walls may **not** be removed by the exhibitor. The retaining walls will be placed on the stand for which the partition walls were ordered.

All prices quoted are subject to the statutory VAT valid at this time (according to the relevant version of the Value Added Tax Act).

The stated service can only be performed if at the time there are no outstanding payments owed to LMS.

It is explicitly stated that data will be stored according to A 14 of the General Terms and Conditions for Services A.

Date: \_\_\_\_\_ 2 0 \_\_\_\_\_

Place: \_\_\_\_\_

Company stamp and signature: \_\_\_\_\_



Landesmesse Stuttgart GmbH  
 Messepiazza 1 · 70629 Stuttgart (Germany)  
 Tel.: +49 711 18560-2444  
 E-mail: sms@messe-stuttgart.de

For questions please contact:  
 Stand Construction Services  
 Tel.: +49 711 18560-2400  
 E-mail: standconstruction@messe-stuttgart.de

Event name	Company name (Invoice recipient)
Customer no. (Exhibitor)	Contact person (Invoice recipient)
Hall/stand no. (Exhibitor)	Street and house no. (Invoice recipient)
Your order no. (if desired)	Postcode, town, country (Invoice recipient)
VAT identification number EU (Invoice recipient)	Telephone (in case of questions)
We are: <input type="checkbox"/> Entrepreneur <input type="checkbox"/> no Entrepreneur	E-mail (in case of questions)

Orders by fax to: +49 711 18560-2292

## 012211802

We herewith order / We order on behalf and by order of the aforementioned exhibitor from Landesmesse Stuttgart GmbH (LMS) – and at the same time accept the General Terms and Conditions for Services as well as the Technical Guidelines of LMS which are available at [www.messe-stuttgart.de/agb](http://www.messe-stuttgart.de/agb) and also on-site in the service center – as follows:

Item No.	Variant	Quantity	Description	Unit price EUR
61-122	0 4		Wall element M&S light grey, plastic-coated, 990 x 2500 mm, 16 mm	43.00 / lin. m.
61-122	1 7		Wall element M&S maple, plastic-coated, 990 x 2500 mm, 16 mm	43.00 / lin. m.
61-228	0 3		Wall element M&S with textile cover (suitable for use with pins), anthracite, sound-absorbing, 990 x 2500 mm, 16 mm	43.00 / lin. m.
61-138	9 9		Wall element M&S (with OSB-filling) wall filling: oriented strand board natural, 990 x 2500 x 16mm	43.00 / lin. m.
61-135	0 1		Fascia board, white, 2500 x 400 mm incl. standard lettering (Helvetica, semibold, black), max. 20 letters	81.50 / pc.
61-136	0 1		Fascia board, white, 1500 x 400 mm incl. standard lettering (Helvetica, semibold, black), max. 20 letters	55.00 / pc.
61-137	0 1		Fascia board, white, 2000 x 300 mm incl. standard lettering (Helvetica, semibold, black), max. 20 letters	59.00 / pc.
61-123	0 4		One-leaf door element, satin-frosted glass	112.00 / pc.

Exact text for your fascia lettering (please complete) \_\_\_\_\_

Stand partition walls are **not included** in the stand area rental. Please note that for static reasons it is absolutely necessary to install **retaining walls** every 4 linear metres. The number and placement of these walls depends on the stand shape and size and can be seen in the stand sketch. These walls may **not** be removed by the exhibitor. The retaining walls will be placed on the stand for which the partition walls were ordered.

All prices quoted are subject to the statutory VAT valid at this time (according to the relevant version of the Value Added Tax Act).

The stated service can only be performed if at the time there are no outstanding payments owed to LMS.

It is explicitly stated that data will be stored according to A 14 of the General Terms and Conditions for Services A.

Date: \_\_\_\_\_ 2 0 \_\_\_\_\_

Place: \_\_\_\_\_

Company stamp and signature \_\_\_\_\_