

## Top view

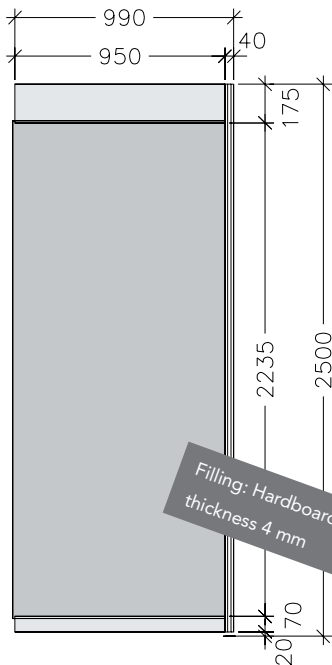

## Front view



## Wall element OCTANORM

comprising:

- **Supports:** 8-chamber profile Ø 40 mm, 2500 mm incl. height adjustable base, 20 mm
- **Struts:** top: 175 mm x 16 mm x 950 mm  
bottom: 70 mm x 16 mm x 950 mm
- **Wall filling:** Hardboard, plastic-coated, white thickness 4 mm

**Please note:** For statistical reasons it is necessary to install a retaining wall every 4 lin. metres.

see form 1.18 01

## Top view

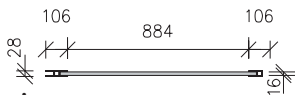

## Front view

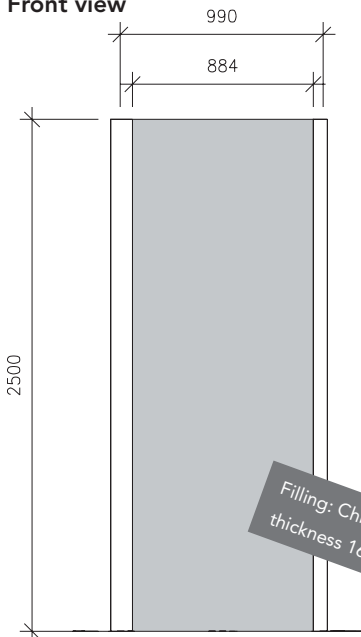

## Wall element M&S

comprising:

- System fastener in silver (28 mm x 106 mm for straight fastening)
- Wall element, plastic-coated surface, colour: light grey RAL 7035, Visual range: 884 mm x 2500 mm x 16 mm
- Also available with textile cover in anthracite (pins may be used, sound-absorbing) and maple decor and with cover in your preferred colour (at a surcharge)

**Please note:** For statistical reasons it is necessary to install a retaining wall every 4 lin. metres.

see form 1.18 02



Event name	Company name (Invoice recipient)
Customer no. (Exhibitor)	Contact person (Invoice recipient)
Hall/stand no. (Exhibitor)	Street and house no. (Invoice recipient)
Your order no. (if desired)	Postcode, town, country (Invoice recipient)
VAT identification number EU (Invoice recipient)	Telephone (in case of questions)
We are: <input type="checkbox"/> Entrepreneur <input type="checkbox"/> no Entrepreneur	E-mail (in case of questions)

Orders by fax to: +49 711 18560-2292

## 012011801

We herewith order / We order on behalf and by order of the aforementioned exhibitor from Landesmesse Stuttgart GmbH (LMS) – and at the same time accept the General Terms and Conditions for Services as well as the Technical Guidelines of LMS which are available at [www.messe-stuttgart.de/agb](http://www.messe-stuttgart.de/agb) and also on-site in the service center – as follows:

Item No.	Variant	Quantity	Description	Unit price EUR
01-120	0 1		Wall element OCTANORM white, plastic-coated 990 x 2500 x 4 mm	43.00 / lin. m.
01-021	9 9		Wall element OCTANORM coated with cork, suitable for use with pins, 990 x 2500 mm	44.70 / lin. m.
01-122	9 9		Wall element OCTANORM (with OSB-filling) wall filling: oriented strand board natural, 990 x 2500 x 16 mm	43.00 / lin. m.
01-156	0 1		Fascia, white, 4 mm, 2500 x 400 mm, to be fixed to wall element, incl. standard lettering (Helvetica, semibold, black), max. 20 letters	75.70 / pc.
01-157	0 1		Fascia, white, 4 mm, 1500 x 400 mm, to be fixed to wall element, incl. standard lettering (Helvetica, semibold, black), max. 20 letters	50.90 / pc.
01-605	0 1		One-leaf door element, white	115.80 / pc.

Exact text for your fascia lettering (please complete) \_\_\_\_\_

Stand partition walls are **not included** in the stand area rental. Please note that for static reasons it is absolutely necessary to install **retaining walls** every 4 linear metres. The number and placement of these walls depends on the stand shape and size and can be seen in the stand sketch. These walls may **not** be removed by the exhibitor. The retaining walls will be placed on the stand for which the partition walls were ordered.

All prices quoted are subject to the statutory VAT valid at this time (according to the relevant version of the Value Added Tax Act).

The stated service can only be performed if at the time there are no outstanding payments owed to LMS.

It is explicitly stated that data will be stored according to A 14 of the General Terms and Conditions for Services A.

Date: \_\_\_\_\_ 2 0

Place: \_\_\_\_\_

Company stamp and signature \_\_\_\_\_



Landesmesse Stuttgart GmbH  
Messepiazza 1 · 70629 Stuttgart (Germany)  
Tel.: +49 711 18560-2444  
E-mail: sms@messe-stuttgart.de

For questions please contact:  
Stand Construction Services  
Tel.: +49 711 18560-2400  
E-mail: standconstruction@messe-stuttgart.de

Event name	Company name (Invoice recipient)
Customer no. (Exhibitor)	Contact person (Invoice recipient)
Hall/stand no. (Exhibitor)	Street and house no. (Invoice recipient)
Your order no. (if desired)	Postcode, town, country (Invoice recipient)
VAT identification number EU (Invoice recipient)	Telephone (in case of questions)
We are: <input type="checkbox"/> Entrepreneur <input type="checkbox"/> no Entrepreneur	E-mail (in case of questions)

Orders by fax to: +49 711 18560-2292

012011802

We herewith order / We order on behalf and by order of the aforementioned exhibitor from Landesmesse Stuttgart GmbH (LMS) – and at the same time accept the General Terms and Conditions for Services as well as the Technical Guidelines of LMS which are available at [www.messe-stuttgart.de/agb](http://www.messe-stuttgart.de/agb) and also on-site in the service center – as follows:

Item No.	Variant	Quantity	Description	Unit price EUR
61-122	0 4		Wall element M&S light grey, plastic-coated, 990 x 2500 mm, 16 mm	43.00 / lin. m.
61-122	1 7		Wall element M&S maple, plastic-coated, 990 x 2500 mm, 16 mm	43.00 / lin. m.
61-228	0 3		Wall element M&S with textile cover (suitable for use with pins), anthracite, sound-absorbing, 990 x 2500 mm, 16 mm	43.00 / lin. m.
61-138	9 9		Wall element M&S (with OSB-filling) wall filling: oriented strand board natural, 990 x 2500 x 16mm	43.00 / lin. m.
61-135	0 1		Fascia board, white, 2500 x 400 mm incl. standard lettering (Helvetica, semibold, black), max. 20 letters	79.00 / pc.
61-136	0 1		Fascia board, white, 1500 x 400 mm incl. standard lettering (Helvetica, semibold, black), max. 20 letters	53.00 / pc.
61-123	0 4		One-leaf door element, satin-frosted glass	112.00 / pc.

Exact text for your fascia lettering (please complete) \_\_\_\_\_

Stand partition walls are **not included** in the stand area rental. Please note that for static reasons it is absolutely necessary to install **retaining walls** every 4 linear metres. The number and placement of these walls depends on the stand shape and size and can be seen in the stand sketch. These walls may **not** be removed by the exhibitor. The retaining walls will be placed on the stand for which the partition walls were ordered.

All prices quoted are subject to the statutory VAT valid at this time (according to the relevant version of the Value Added Tax Act).

The stated service can only be performed if at the time there are no outstanding payments owed to LMS.

It is explicitly stated that data will be stored according to A 14 of the General Terms and Conditions for Services A.

Date: \_\_\_\_\_ 2 0 \_\_\_\_\_

Place: \_\_\_\_\_

Company stamp and signature: \_\_\_\_\_



Landesmesse Stuttgart GmbH  
Messepiazza 1 · 70629 Stuttgart (Germany)  
Tel.: +49 711 18560-2444  
E-mail: sms@messe-stuttgart.de

For questions please contact:  
Stand Construction Services  
Tel.: +49 711 18560-2400  
E-mail: standconstruction@messe-stuttgart.de